

Welcome to the world of Hello Kitty. My friends at Emerson Radio Corp. are producing this Hello Kitty Portable CD/CD-R/CD-RW Player, Stereo Cassette Recorder, AM/FM Stereo Radio under license from Sanrio Company Ltd. Read this manual before operating this unit to become familiar with its features and obtain the performance that will bring you continued enjoyment for many years. In the event you require technical assistance, please contact my friends at the Emerson Radio Consumer Affairs Department at 800-898-9020. Retain this manual for future reference.

In the space provided, record the serial number.

Serial Number _____

	CAUTION RISK OF ELECTRIC SHOCK DO NOT OPEN	
<p>CAUTION: TO REDUCE THE RISK OF ELECTRIC SHOCK, DO NOT REMOVE COVER (OR BACK). NO USER-SERVICEABLE PARTS INSIDE. REFER SERVICING TO QUALIFIED SERVICE PERSONNEL.</p>		

LASER SAFETY: This unit employs a laser. Only qualified service personnel should attempt to service this device due to possible eye injury.

CAUTION: USE OF CONTROLS, ADJUSTMENTS OR PERFORMANCE PROCEDURE HEREIN MAY RESULT IN HAZARDOUS RADIATION EXPOSURE.

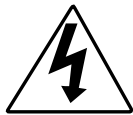

DANGEROUS VOLTAGE
The lightning flash with arrowhead symbol, within an equilateral triangle is intended to alert the user to the presence of uninsulated dangerous voltage within the product's enclosure that may be of sufficient magnitude to constitute a risk of electric shock to persons.



ATTENTION
The exclamation point within an equilateral triangle is intended to alert the user to the presence of important operating and maintenance (servicing) instructions in the literature accompanying the appliance.

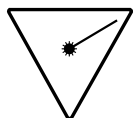

DANGER:
Invisible and hazardous laser radiation when open and interlock failed or defeated. Avoid direct exposure to beam.

FCC WARNING:
This equipment may generate or use radio frequency energy. Changes or modifications to this equipment may cause harmful interference unless the modifications are expressly approved in the instruction manual. The user could lose the authority to operate this equipment if an unauthorized change or modification is made.

INFORMATION
This equipment has been tested and found to comply with the limits for a Class B digital device, pursuant to Part 15 of the FCC Rules. These limits are designed to provide reasonable protection against harmful interference in a residential installation. This equipment generates, uses, and can radiate radio frequency energy and, if not installed and used in accordance with the instructions, may cause harmful interference to radio communications. However, there is no guarantee that interference will not occur in a particular installation. If this equipment does cause harmful interference to radio or television reception, which can be determined by turning the equipment off and on, the user is encouraged to try to correct the interference by one or more of the following measures:

- Reorient or relocate the receiving antenna.
- Increase the separation between the equipment and receiver.
- Connect the equipment into an outlet on a circuit different from that to which the receiver is connected.
- Consult the dealer or an experienced radio/TV technician for help.

PREPARATION FOR USE

Unpacking and Setup

- Carefully remove the unit from the display carton and remove all packing material from the unit itself.
- Remove any descriptive labels that may be found on either the front or top cabinet of the unit. Do not remove any labels located on either the back or bottom cabinet of the unit.
- The detachable AC power cord is packed in the carton separately from the unit. Make sure that the AC power cord is not accidentally discarded with the carton or packing material.
- Press the CD Door OPEN Button to open the CD compartment door. There is a white card in the CD compartment which is intended to prevent the CD pickup from moving during shipment of the product. Remove this card from the CD compartment before use.

Power Sources

This portable audio system is designed to operate on either 120V AC 60Hz house current or 12V DC, using 8 'C' batteries (UM-2), not included. Attempting to operate this unit from any other power source may cause damage to the unit, which is not covered by your warranty.

AC Operation

Unwind the AC cord and extend it to its full length. Insert the small end of the AC cord into the AC socket on the back cabinet of the unit. Insert the other end of the AC cord into any convenient 120V 60 Hz household outlet.

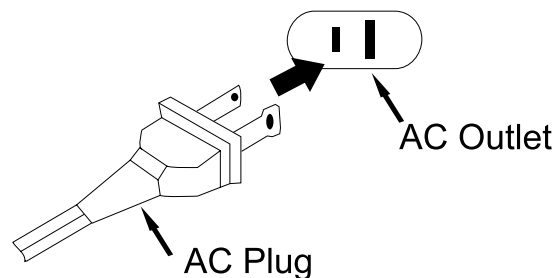

Please note that this unit is equipped with a polarized AC plug which has one blade wider than the other. This is a safety feature to reduce the likelihood of electric shock. This polarized AC plug will only fit in a polarized AC outlet. If you find that you cannot insert this plug into your outlet, you may have an obsolete non-polarized outlet. Please do not try to defeat this safety feature by using a non-polarized adapter or by filing the wider blade to make it fit into your outlet. If this plug does not fit into your outlet, you should contact a qualified licensed electrician to replace your obsolete outlet.

Battery Operation

The battery compartment is located on the back of the cabinet.

- Remove the battery compartment door by pressing downward on the two tabs as shown in figure 1 below.
- Insert 8 'C' size (UM-2) batteries into the battery compartment as shown in figure 2 below. Be sure to observe the polarity markings which are engraved inside the battery compartment. If the batteries are inserted incorrectly, the unit will not operate.

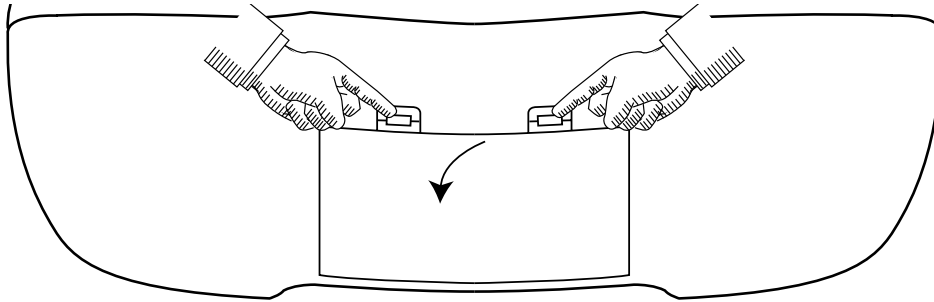

Figure 1

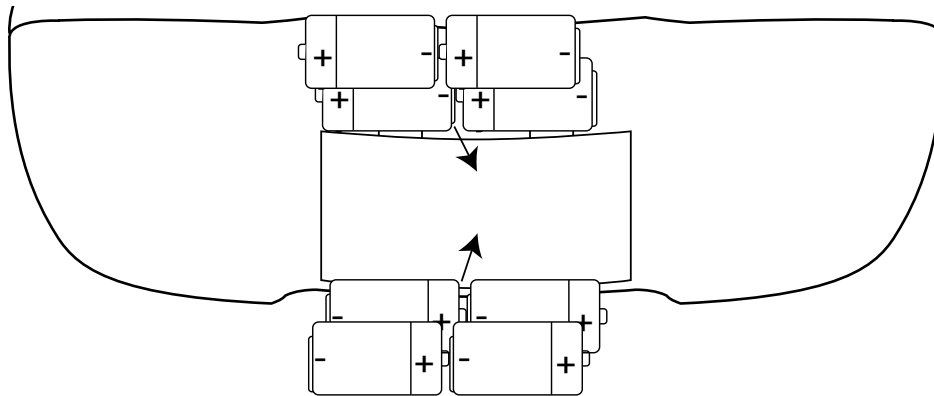

Figure 2

- Replace the battery compartment door.

NOTE: The AC power cord must be disconnected from the AC socket on the back of the unit in order for the unit to operate on battery power.

BATTERY PRECAUTIONS

Follow these precautions when using batteries in this device:

1. Use only the size and type of batteries specified.
2. Be sure to follow the correct polarity when installing the batteries as indicated in the battery compartment. Reversed batteries may cause damage to the device.
3. Do not mix different types of batteries together (e.g. Alkaline and Carbon-zinc) or old batteries with fresh ones.
4. If the device is not to be used for a long period of time, remove the batteries to prevent damage or injury from possible battery leakage.
5. Do not try to recharge batteries not intended to be recharged; they can overheat and rupture. (Follow battery manufacturer's directions.)

LOCATION OF CONTROLS AND INDICATORS

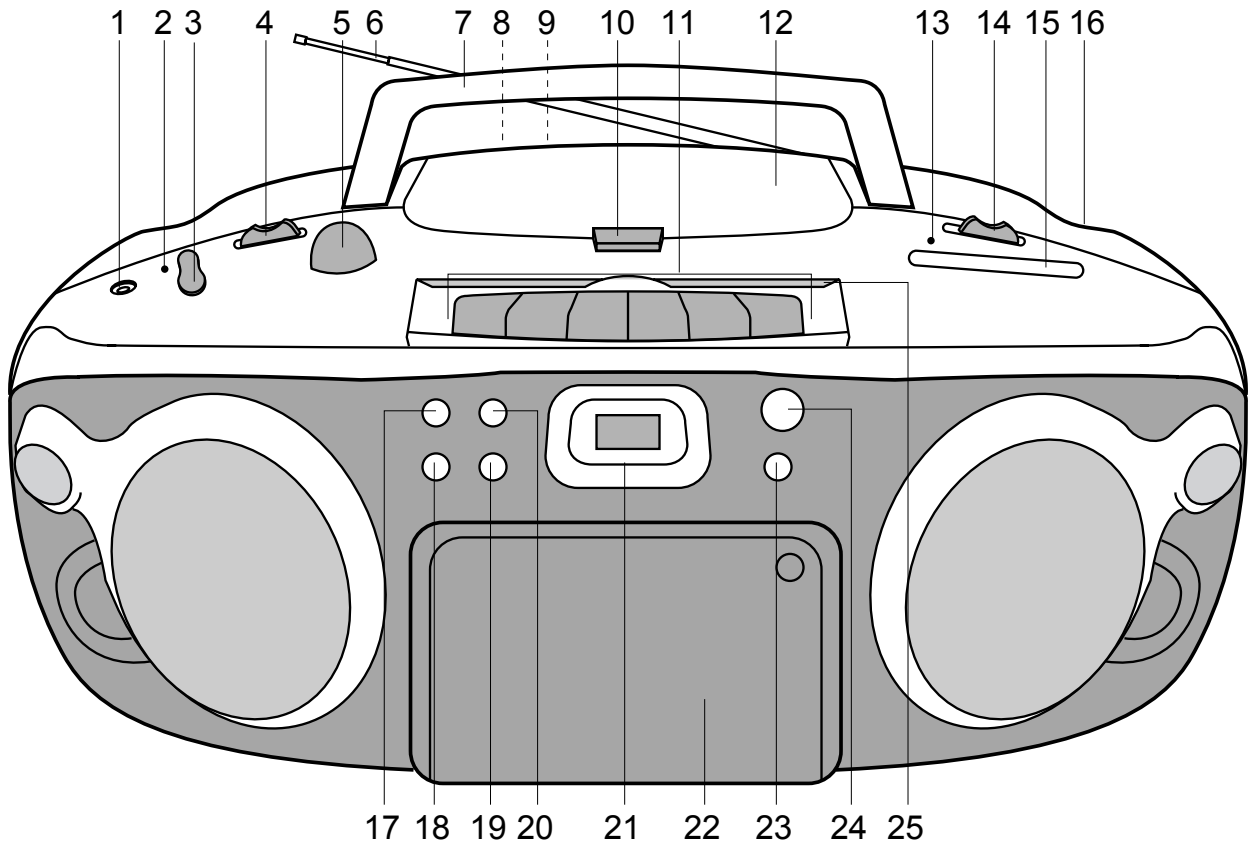

- | | |
|---|--|
| <ol style="list-style-type: none"> 1. Stereo Headphone Jack 2. STEREO-WIDE Indicator 3. STEREO-WIDE Button 4. FUNCTION Switch (TAPE (Off)/RADIO/CD) 5. VOLUME Control 6. FM Rod Antenna 7. Carrying Handle 8. AC Socket (Rear of Unit) 9. Battery Compartment (Rear of Unit) 10. CD Door OPEN Button 11. Cassette Buttons (under control cover):
 PAUSE ()
 STOP/EJECT (■▲)
 FAST FORWARD (◀◀)
 REWIND (▶▶)
 PLAY (▶)
 RECORD (●) 12. CD Compartment Door | <ol style="list-style-type: none"> 13. FM STEREO LED Indicator 14. BAND Switch (AM/FM/FM STEREO) 15. Tuning Dial 16. TUNING Control 17. CD PROGRAM Button 18. CD REPEAT Playback Button 19. CD Skip/Search Reverse (◀◀) Button 20. CD Skip/Search Forward (▶▶) Button 21. CD Track Display 22. Cassette Door 23. CD STOP (■) Button 24. CD PLAY/PAUSE (▶) Button 25. Cassette Control Cover |
|---|--|

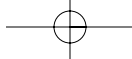

OPERATING INSTRUCTIONS

LISTENING TO THE RADIO

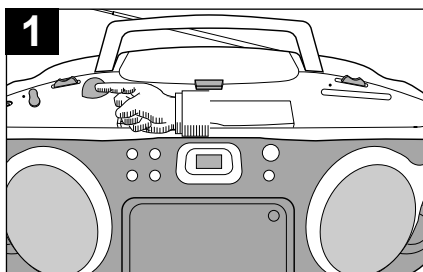

1
Set the VOLUME Control to a low setting.

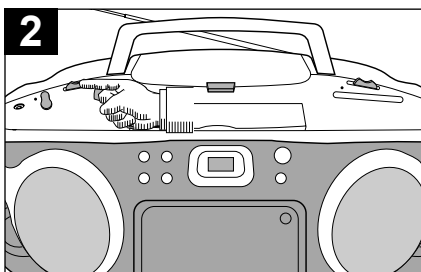

2
Slide the FUNCTION Switch to the RADIO position.

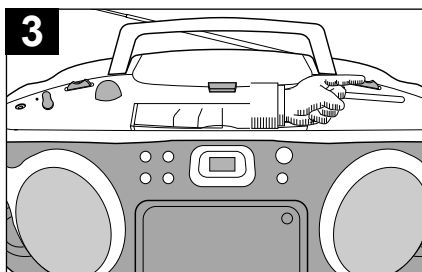

3
Slide the BAND Switch to a desired setting – AM, FM, or FM STEREO.
NOTE: If you select either the FM or FM Stereo bands, be sure to raise the FM rod antenna and extend it to its full length.

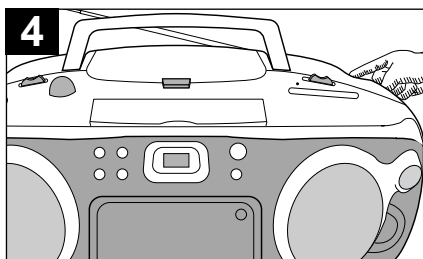

4
Rotate the TUNING Control to find the desired station.
NOTE: If the BAND Switch is set to the FM STEREO position and you have tuned to an FM Stereo station, the FM STEREO LED Indicator will light.

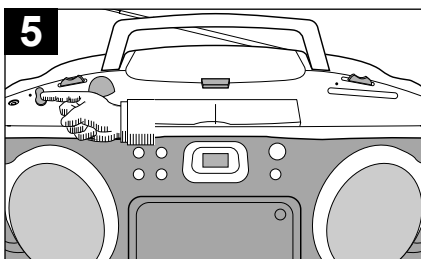

5
If you would like to experience expanded stereo separation, press the STEREO-WIDE Button. The STEREO-WIDE Indicator illuminates and the sound will seem to expand as if the speakers have moved further apart.

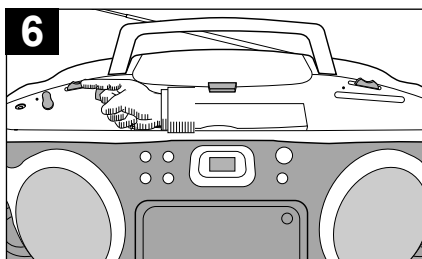

6
When you have finished listening, slide the FUNCTION Switch to the TAPE (Off) position to shut the power off.

Hints for Better Reception

FM - Make sure that the telescopic FM Rod Antenna is raised and extended to its full length. You may have to vary the direction of the antenna to find the strongest signal for each FM station. If you are listening to a weak or distant FM Stereo station and reception is unsatisfactory, slide the BAND Switch to the FM (Mono) position. This will normally provide an improvement in reception, although the sound will no longer be in stereo.

AM - The AM ferrite bar antenna is located inside the cabinet. It may be necessary to turn the unit slightly so that the internal antenna is pointing in the direction of the AM transmitter. You may have to experiment to find the position that provides the strongest reception for each of your favorite AM stations.

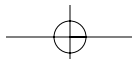

PLAYING COMPACT DISCS

NORMAL PLAYBACK

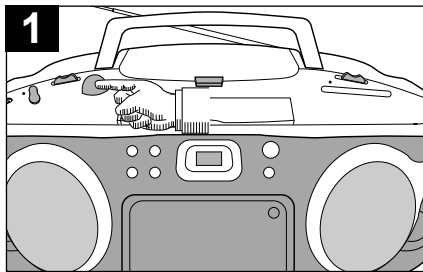

1
Set the VOLUME Control to a low setting.

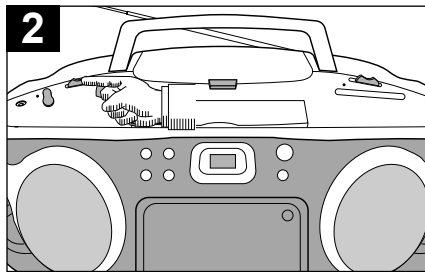

2
Slide the FUNCTION Switch to the CD position.

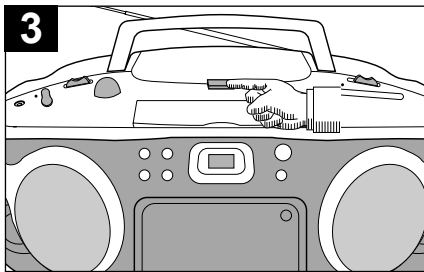

3
Press the CD Door OPEN Button to open the CD compartment door.

NOTE: If you have not already done so, remove the white CD transit lock card from the CD compartment now and discard it.

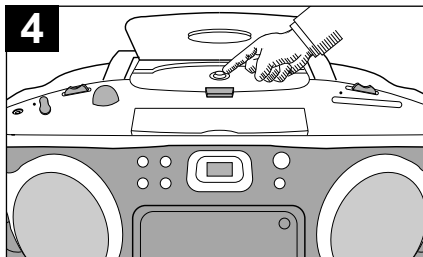

4
Place a CD on the center spindle, with the printed label side facing up. Close the CD compartment door.

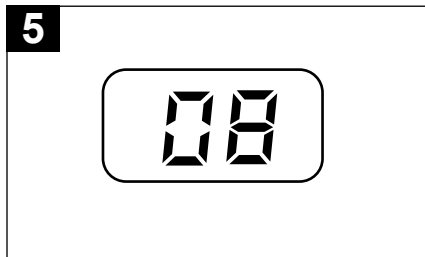

5
The CD player will read the table of contents on the disc and the total number of tracks on the disc will appear on the CD Track Display.

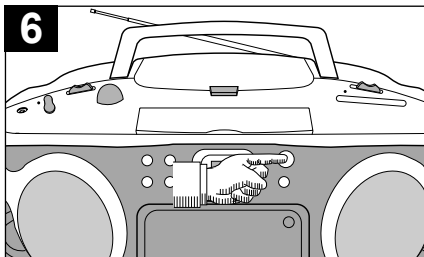

6
Press the CD PLAY/PAUSE (▶||) Button to begin playback on Track 1.

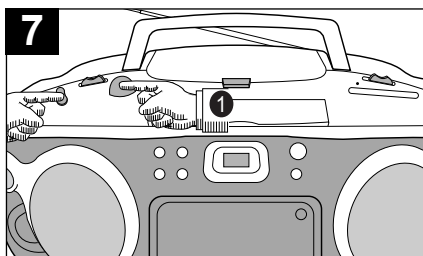

7
Adjust the VOLUME **1** and STEREO-WIDE **2** Controls, as desired. Playback will continue until all the tracks on the disc have been played.

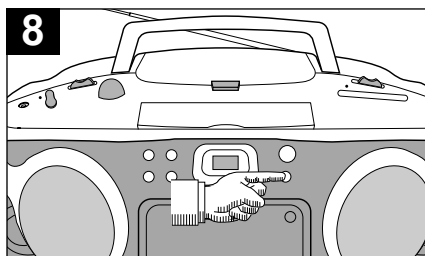

8
To stop playback before the disc ends, press the CD STOP (■) Button. The disc will stop and the display will show the total number of tracks on the disc.

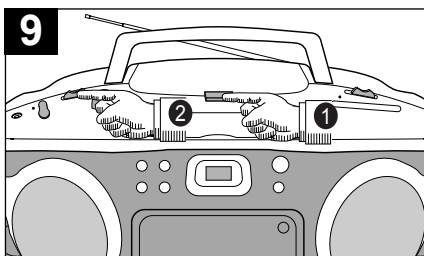

9
After the last track has been played, the disc stops automatically and the display shows the total number of tracks on the disc. If you are finished listening, press the CD Door OPEN Button **1** to open the CD Compartment door. Remove your disc, close the CD Compartment door and slide the FUNCTION Switch **2** to the TAPE(Off) position.

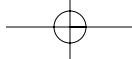

CD PAUSE CONTROL

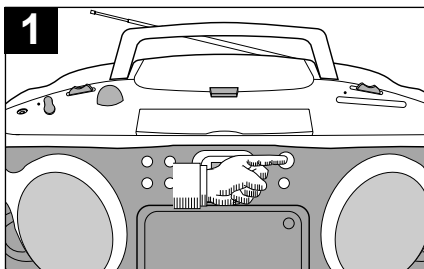

1 During CD playback, if you wish to Pause the disc momentarily, press the CD PLAY/PAUSE (▶||) Button again. Playback stops but the disc continues to spin and the track number flashes in the CD Display.

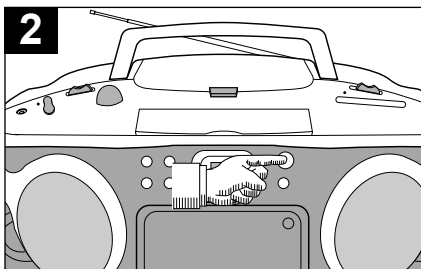

2 Press the CD PLAY/PAUSE (▶||) Button again to release Pause and resume normal CD playback. The sound returns and the CD Track Display stops flashing.

TO BEGIN PLAYBACK FROM A SPECIFIC TRACK

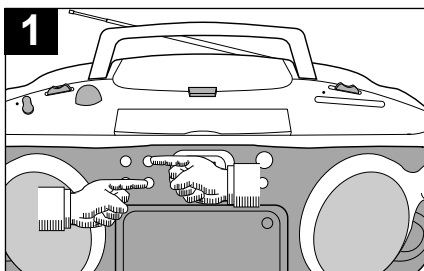

1 After you insert the disc into the CD player and the total number of tracks appear on the display, you may press either the Skip/Forward (▶▶) or Skip/Reverse (◀◀) Buttons to select a specific track for playback.

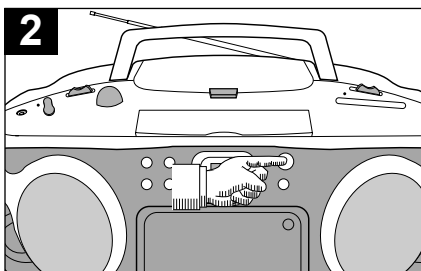

2 When the desired track number appears in the display, press the CD PLAY/PAUSE (▶||) Button. Playback will begin on the track you selected.

FORWARD/REVERSE SKIP TRACK AND HIGH-SPEED MUSIC SEARCH (▶▶/◀◀)

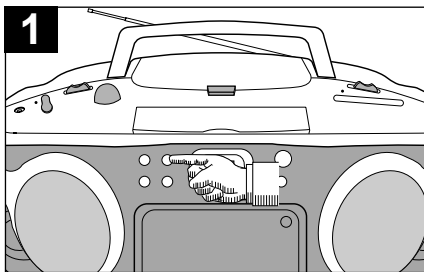

1 During playback, press the Skip/Forward (▶▶) Button once to advance the player to the beginning of the next track. Press the Skip/Forward (▶▶) Button repeatedly to advance the player to higher number tracks.

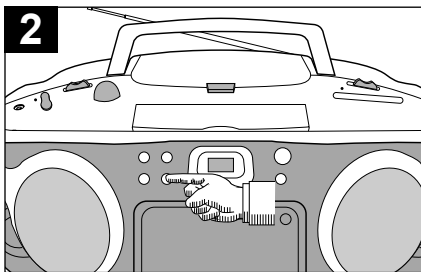

2 During playback, press the Skip/Reverse (◀◀) Button once to move the player back to the beginning of the previous track. Press the Skip/Reverse (◀◀) Button repeatedly to move the player back to lower-numbered tracks.

3 During playback, depress and hold either the Skip/Forward (▶▶) or Skip/Reverse (◀◀) Buttons to move the player forward or backward within a track to locate a specific musical passage. The player will move forward or backward at high speed as long as the buttons are depressed. When you release the Skip/Forward (▶▶) or Skip/Reverse (◀◀) Button, normal playback will resume at that point.

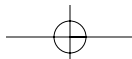

REPEAT PLAYBACK

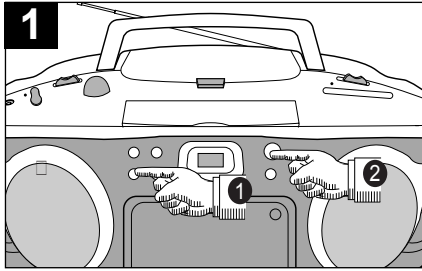

To repeat all of the tracks on a disc continuously, press the REPEAT Button ❶ once. The Repeat indicator appears in the display. Press the CD PLAY/PAUSE (▶||) Button ❷ to begin all tracks repeat.

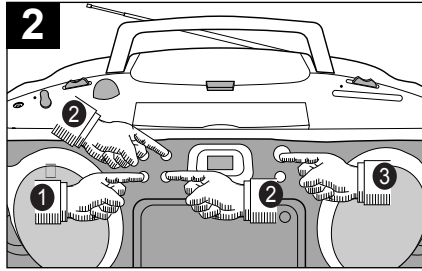

To repeat a single track, press the REPEAT Button ❶ twice. The Repeat 1 indicator will appear in the display. Press the Skip/Forward (▶▶) or Skip/Reverse (◀◀) Buttons ❷ to select the specific track that you wish to repeat. When the desired track number appears in the display, press the CD PLAY/PAUSE (▶||) Button ❸ to begin playback. The specific track you selected will be repeated continuously.

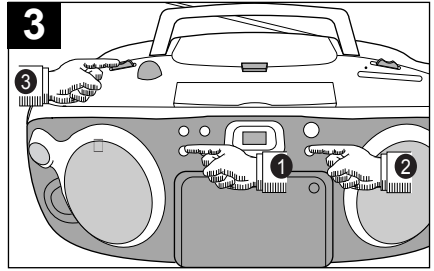

To cancel Repeat Playback, press the REPEAT Button ❶ until the Repeat indicator disappears from the display. You can also cancel Repeat Playback by pressing the CD STOP (■) Button ❷ or by setting the FUNCTION Switch ❸ to the TAPE(Off) position.

PROGRAMMED PLAYBACK

The CD player in this unit has a 20-track programmable memory that allows you to program up to 20 tracks on any disc for playback in any desired order. You may program 20 different tracks or you may also program certain tracks to play more than once.

To perform programmed playback, proceed as follows:

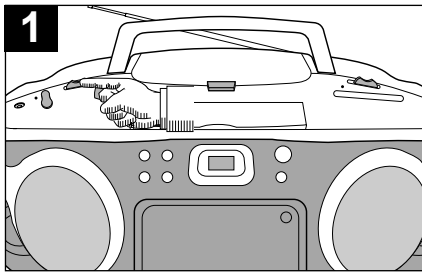

Set the FUNCTION Switch to the CD position.

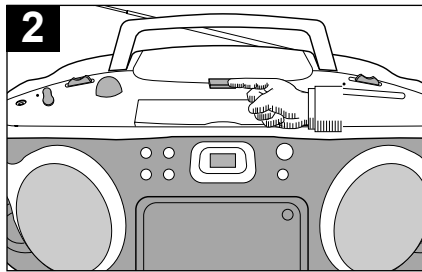

Open the CD Compartment door and insert your disc in the CD player. Close the CD compartment door. Wait for the CD player to read the table of contents and display the total number of tracks on the disc.

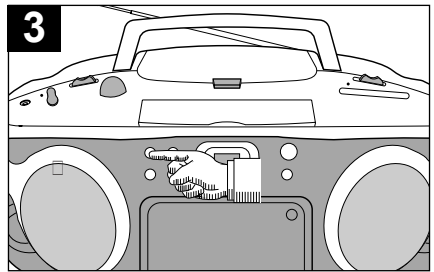

Press the CD PROGRAM Button. The Program indicator appears in the display and the Program Memory #1 flashes.

PROGRAMMED PLAYBACK SECTION CONTINUED ON NEXT PAGE.

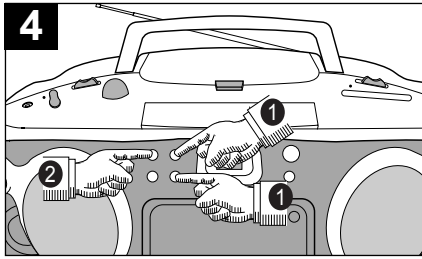

Press the Skip/Forward (▶▶) or Skip/Reverse (◀◀) Buttons ❶ to select the first track that you wish to program. Example: Track 5. When the desired track number (Example: Track 5) is flashing in the display, press the CD PROGRAM Button ❷ again. The display will briefly show Program Memory #1 and then your desired track number (Example: Track 5) will resume flashing. This confirms that Track 5 has been entered into CD Program Memory #1.

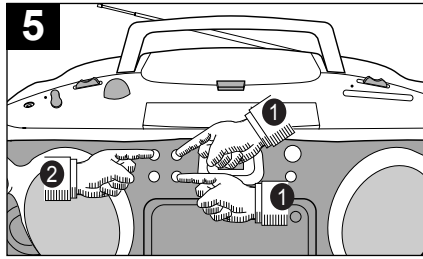

Press either the Skip/Forward (▶▶) or Skip/Reverse (◀◀) Buttons ❶ to select the next track you wish to program (Example: Track 8). When Track 8 is flashing in the display, press the PROGRAM Button ❷ again. The display will briefly show Program Memory #2 and then Track 8 will resume flashing. This confirms that Track 8 has been entered into CD Program Memory #2.

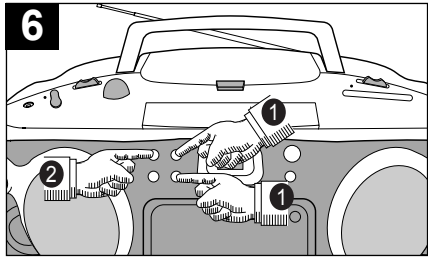

Repeat step 5, selecting a different track each time, until you have programmed up to 20 track numbers into the CD Program Memory.

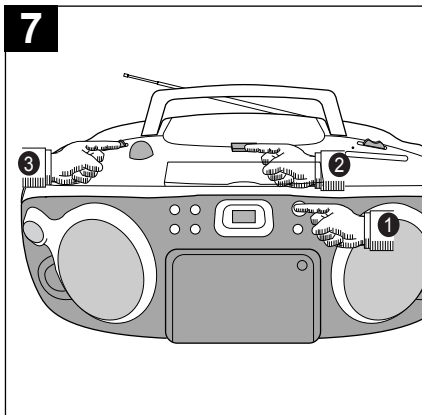

After programming up to 20 tracks in the CD Program Memory, press the CD PLAY/PAUSE (▶||) Button ❶ to begin programmed playback. The Program indicator will begin flashing in the display and playback will begin on the first track that you programmed. The player will continue to play all of the tracks that you programmed in the order in which you programmed them. When the last programmed track has been played, the player will stop and the display will again show the total number of tracks on the disc. The Program indicator remains in the display and the program is still active. If you press the Program button and then press the CD PLAY/PAUSE button ❶ again, playback will start on the first track you programmed and will continue until all the programmed tracks have been played. To cancel the Programmed Playback mode, press the CD Door OPEN Button ❷ to open the CD Compartment Door or set the FUNCTION Switch ❸ to the RADIO or TAPE(Off) positions.

PROGRAMMED REPEAT

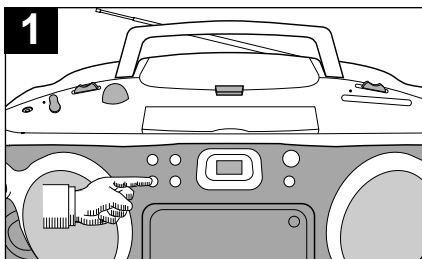

It is also possible to use the Program and Repeat functions together to repeat a specific program indefinitely. First, program the tracks you wish to hear in the order you wish to hear them, as described above. Then, press the REPEAT Button once. Both the Program and Repeat indicators will appear in the display.

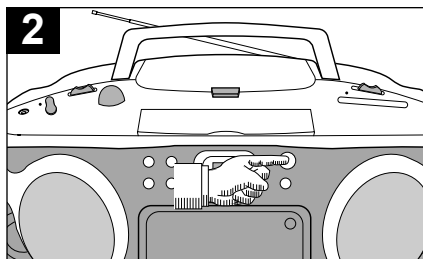

Press the CD PLAY/PAUSE (▶||) Button to begin programmed repeat playback. The player will play the tracks you selected in the order in which you programmed them. When the last track in the program has been played, the entire program will begin again.

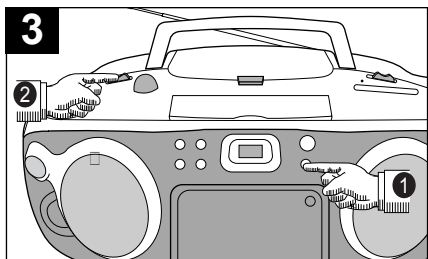

Program Repeat operation will continue indefinitely until you press the CD STOP (■) Button ❶, open the CD door or set the FUNCTION Switch ❷ to the RADIO or TAPE (Off) position.

PLAYING CASSETTE TAPES

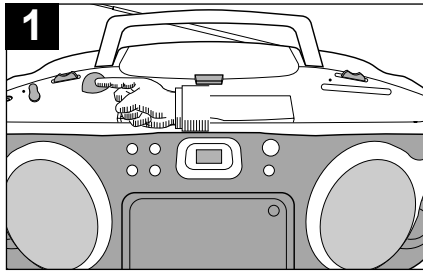

1 Set the VOLUME Control to a low setting.

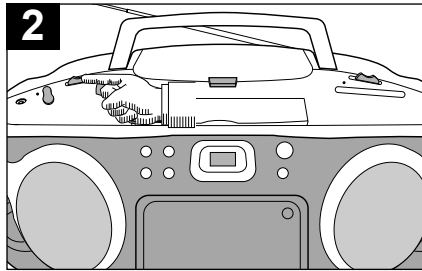

2 Slide the FUNCTION Switch to the TAPE position.

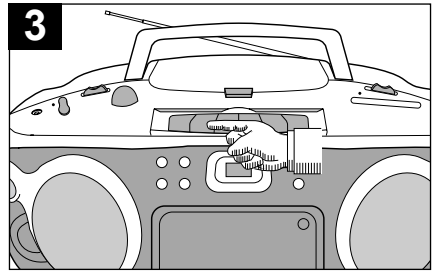

3 Open the Cassette Control Cover to expose the cassette controls and press the Stop/Eject (■▲) Button to open the Cassette Door.

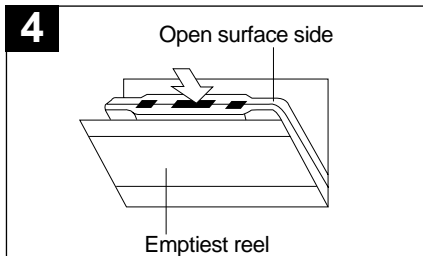

4 Insert a pre-recorded cassette into the slots in the Cassette Door with the open end facing up and the full reel on the right side. Close the cassette door.

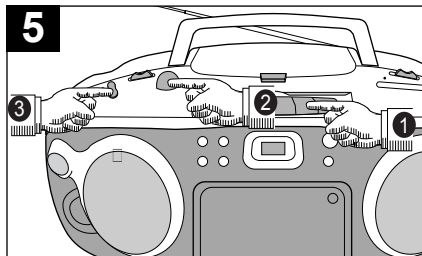

5 Press the cassette Play (▶) Button ① to begin playback. Adjust the VOLUME ② and STEREO-WIDE ③ Controls as desired.

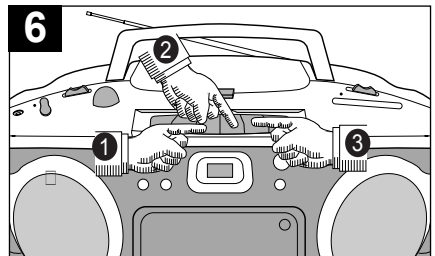

6 To advance or rewind the tape rapidly, press either the cassette Fast Forward (▶▶) ① or Rewind (◀◀) ② buttons. When you reach the desired point, press the cassette Play (▶) Button ③ to resume normal playback.

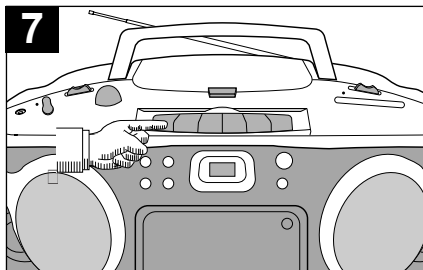

7 To pause playback momentarily, press the cassette Pause (||) Button. The tape movement stops but the tape motor is still running. Press the cassette Pause (||) Button again to release Pause and resume normal playback.

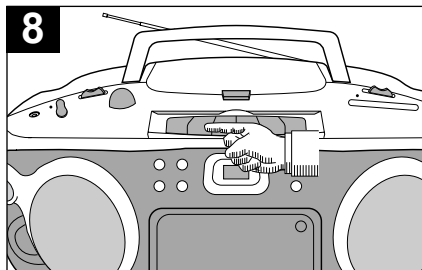

8 To stop playback before the tape ends, press the Stop/Eject (■▲) Button. The PLAY Button is released and the tape motor shuts off.

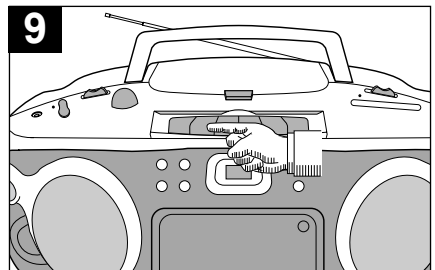

9 When the tape reaches the end, the auto-stop mechanism activates, the tape PLAY Button is released and the tape motor shuts off. Press the Stop/Eject (■▲) Button to open the Cassette Door and remove the tape.

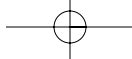

MAKING A TAPE RECORDING

The tape recorder in this system allows you to make direct recordings from the radio or CD player to a blank cassette in the tape compartment. An automatic recording volume level control (ALC) circuit will automatically control the volume level of your recordings to prevent distortion. You may change the settings of the volume or the Stereo-Wide controls during a tape recording, as these controls have no effect on the material being recorded onto the tape.

To make a tape recording, proceed as follows:

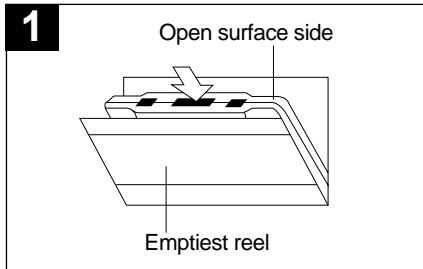

Open the **Cassette Door** and insert a good quality blank cassette tape into the slots on the door, with the open end facing up and the full reel on the right-hand side. Close the **Cassette Door**.

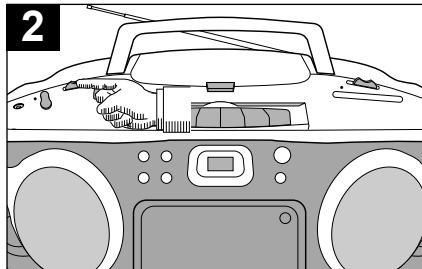

Select the function you wish to record, either radio or CD, and operate that function according to its own instructions.

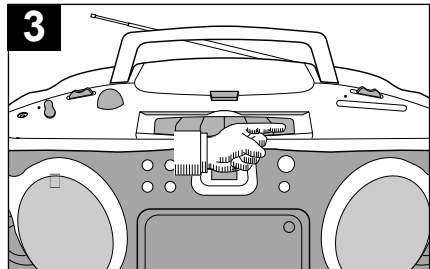

When you are ready to begin recording, press the **cassette Record (●) Button**. The **cassette Play (◀) Button** will also engage. The tape will begin moving and all of the material from your selected source will be recorded on the tape.

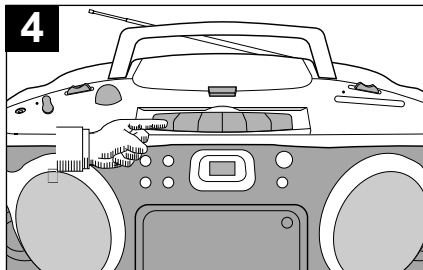

To avoid recording unwanted material, such as radio commercials, use the **Pause (||) Button** to stop the recording temporarily. Release the **Pause (||) Button** to begin recording again.

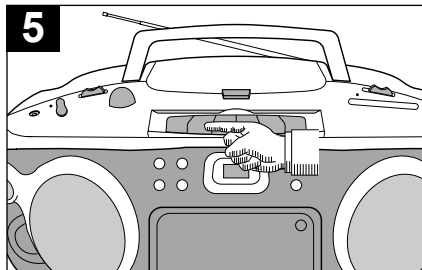

When you are finished recording, press the **Stop/Eject (■▲) Button** to stop the tape.

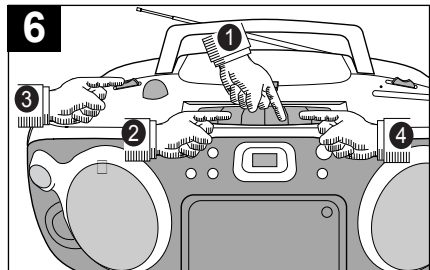

If you wish to listen to your recording immediately, press the **cassette Rewind (▶▶) Button ①** until the tape rewinds to the beginning, then press the **Stop/Eject (■▲) Button ②**. Set the **FUNCTION Switch ③** to the **TAPE** position and press the **cassette Play (◀) Button ④** to begin playback.

HEADPHONE JACK

Connect a pair of stereo headphones (not included) to this jack for private listening without disturbing others. The built-in speakers are shut off when headphones are connected to the headphone jack.

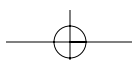



CARE AND MAINTENANCE

SAFEGUARD AGAINST ACCIDENTAL ERASURE

When a new recording is made, any program material previously recorded is automatically erased and only the new recording remains. To safeguard valuable recordings from being erased accidentally, the cassette and the deck are equipped with a special device.

On the back of the cassette there is an erase prevention tab on each side. To prevent accidental erasing, break out these tabs with a screwdriver. If only one side of the tape is to be protected, break out the tab on the left side with the side desired facing you.

To record on a tape in which the tab has been broken, place a piece of adhesive tape over that area.

NOTE: When a tab is broken out, the record button cannot be depressed.

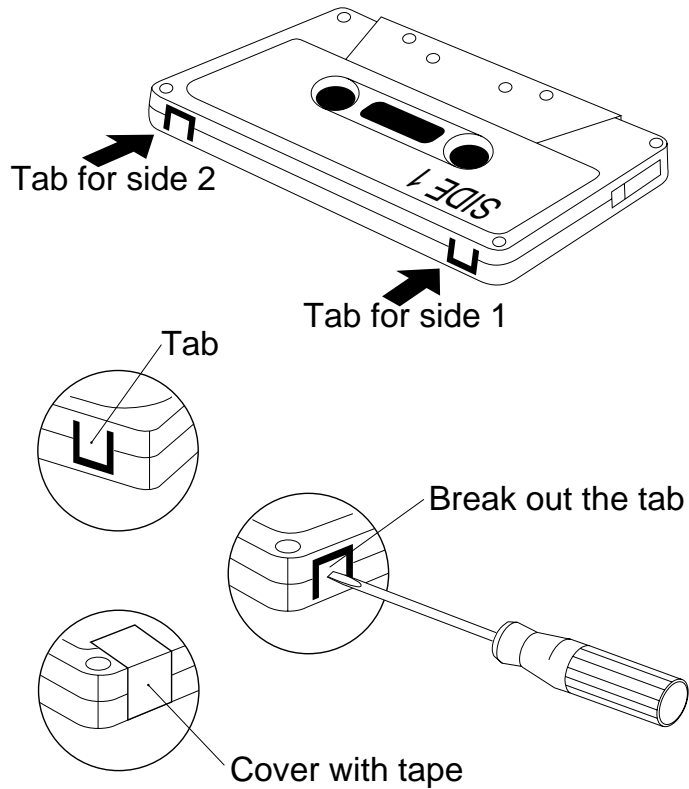

CASSETTE TAPE RECOMMENDATIONS

Standard tape lengths have 15 (C-30), 30 (C-60) and 45 (C-90) minutes of recording time on each side. Longer length tapes of 60 (C-120) minutes of recording time on each side are not recommended. Use only high quality tapes. If a problem develops, check the unit first with another cassette to determine if the problem is with the cassette, and not with the unit.

If there is any slack in the tape in the cassette, it should be removed before inserting the cassette. Place a pencil in one of the hubs and rotate toward the outside of the cassette until all slack is taken up.

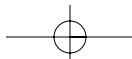
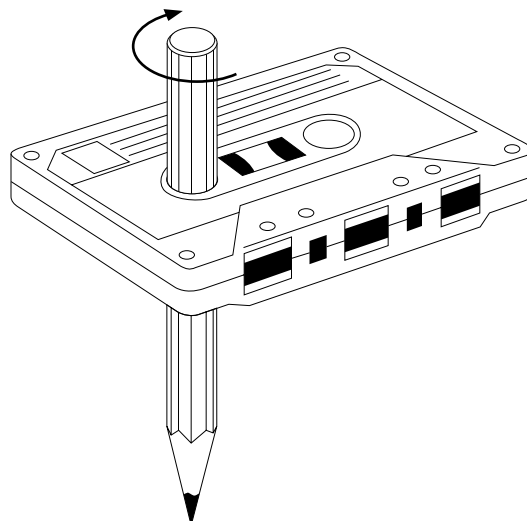

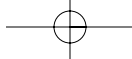

CARE AND MAINTENANCE

Caring for Compact Discs

- Treat the disc carefully. Handle the disc only by its edges. Never allow your fingers to come in contact with the shiny, unprinted side of the disc.
- Do not attach adhesive tape, stickers, etc. to the disc label.
- Clean the disc periodically with a soft, lint-free, dry cloth. Never use detergents or abrasive cleaners to clean the disc. If necessary, use a CD cleaning kit.
- If a disc skips or gets stuck on a section of the disc, it is probably dirty or damaged (scratched).
- When cleaning the disc, wipe in straight lines from the center of the disc to the outer edge of the disc. Never wipe in circular motions.

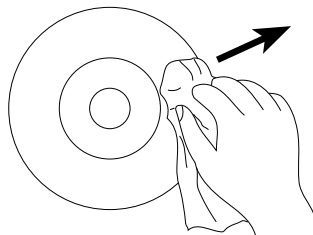
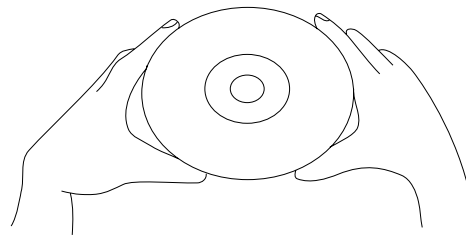

- This unit is designed to play only compact discs bearing the identification logo as shown here.
- Compact Discs should be stored in their cases after each use to avoid damage.
- Do not expose compact discs to direct sunlight, high humidity, high temperatures, or dust, etc. Prolonged exposure or extreme temperatures can warp the disc.
- Do not stick or write anything on either side of the disc. Sharp writing instruments, or the ink may damage the surface.



Cleaning the unit

- To prevent fire or shock hazard, disconnect your unit from the AC power source when cleaning.
- The finish on your unit may be cleaned with a dust cloth and cared for as other furniture. Use caution when cleaning and wiping the plastic parts.
- Mild soap and a damp cloth may be used on the front panel.
- Periodic cleaning of the tape heads, capstan and pinch roller is necessary to maintain good sound reproduction. Clean them after every 100 hours of use or less if playback has deteriorated. Use a cotton swab moistened with head cleaning solution or isopropyl alcohol, then wipe dry with another swab.

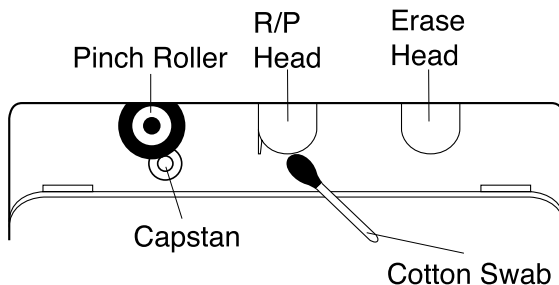

NOTE: Never use metal objects on or near the tape heads. Do not allow any cleaning material to fall into the tape assembly.

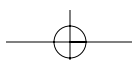

TROUBLESHOOTING GUIDE

Should this unit exhibit a problem, check the following before seeking service.

Symptom	Possible Cause	Solution
Radio		
Noise or sound distorted on radio broadcasts.	Station not tuned properly for AM or FM.	Retune the AM or FM broadcast station.
	FM: Telescopic antenna is not properly adjusted.	Reorient FM telescopic antenna.
	AM: Unit is not positioned correctly.	Rotate unit until best reception is obtained.
FM STEREO indicator does not light.	Poor FM signal being received or BAND switch is not set to FM STEREO.	Retune station, try another station or set BAND switch to FM STEREO.
	Station is not broadcasting in stereo.	Change stations.
AM or FM, no sound.	FUNCTION switch is not set to the RADIO position.	Slide the FUNCTION switch to the RADIO position.
	Volume at minimum.	Increase Volume.
Cassette Player		
No sound.	FUNCTION switch is not set to the TAPE position.	Slide the FUNCTION switch to the TAPE position.
	Volume at minimum.	Increase Volume.
Sound distorted.	Dirty head.	Clean the head.
Speed varies.	Tape old or worn.	Replace the tape.
	Batteries are low.	Replace the batteries.
Cassette Recorder		
Will not record.	Erase prevention tab removed.	Cover hole with adhesive tape.
Distorted sound on playback.	Defective tape or dirty tape head.	Replace tape or clean tape head.
Compact Disc Player		
CD Player will not play.	FUNCTION switch is not set to the CD position.	Slide the FUNCTION switch to the CD position.
	CD is not installed or installed upside-down.	Insert CD with label side up.
CD skips while playing.	Disc is dirty or scratched.	Wipe disc with cloth or use another disc.
General		
No Sound.	Headphones connected into the Headphones jack.	Remove the Headphones from the Headphones jack.

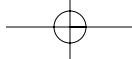

TO FIND THE LOCATION AND
PHONE NUMBER OF YOUR
NEAREST AUTHORIZED
SERVICE CENTER...

CALL TOLL FREE: 1-800-695-0098

**FOR ADDITIONAL SET-UP OR OPERATING ASSISTANCE
PLEASE CALL:
1-800-898-9020**

**FOR CUSTOMER SERVICE, PLEASE WRITE TO:
Emerson Radio Corp.
Consumer Affairs Dept.
1901 Diplomat Drive
Farmers Branch, TX 75234**

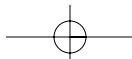

EMERSON RADIO CORP. LIMITED WARRANTY

What does this warranty cover?

Any manufacturing defects in original material, including original parts and workmanship, under normal use and conditions.

For how long?

For a period of ninety (90) days from the date of original purchase in the U.S.

What will we do?

If you need service under this Warranty, and you provide us with the dated proof of purchase, we will provide repair service at no charge for labor and parts at an authorized Depot Repair Facility, or replace the product in our discretion.

How do you make your warranty claim?

If it becomes necessary to repair your unit, you can obtain the name and mailing location of a Depot Repair Facility by dialing 1-800-695-0098. You should pack your unit in a well-padded heavy corrugated box, enclose your check or money order payable to the Depot Repair Facility in the amount of \$9.00 to cover the return shipping and handling costs, and enclose a copy of your proof of purchase (warranty service will not be provided without a dated proof of purchase). Finally, you should ship the unit prepaid via UPS or parcel post (insured).

What does your warranty not cover?

Your warranty does not cover the following :

- Damage from negligence, misuse, abuse, accident, or failure to follow operating instructions.
- Use of product in a commercial application or rentals.
- Changes or repairs by anyone other than an authorized Depot Repair Facility.
- Damage because your unit is improperly connected to the equipment of other manufacturers.
- Unit on which the serial number has been defaced, modified or removed.
- Damage to equipment not properly connected to the product.
- Cost incurred in shipping your unit to and from an authorized Depot Repair Facility.
- Ordinary adjustments which you can perform as outlined in the owner's manual.
- Signal reception problems caused by external antenna or cable systems.
- Products purchased, used, serviced, or damaged outside of the United States.
- Damage to compact discs or cassettes.

What other limitations apply to your warranty ?

THIS WARRANTY IS NON-TRANSFERABLE AND APPLIES ONLY TO THE ORIGINAL PURCHASER AND DOES NOT EXTEND TO SUBSEQUENT OWNERS OF THE PRODUCT. THIS WARRANTY IS VALID ONLY IN THE UNITED STATES OF AMERICA. ANY APPLICABLE IMPLIED WARRANTIES, INCLUDING THE WARRANTY OF MERCHANTABILITY, ARE LIMITED IN DURATION TO A PERIOD OF THE EXPRESSED WARRANTY AS PROVIDED ABOVE BEGINNING WITH THE DATE OF ORIGINAL PURCHASE AT RETAIL AND NO WARRANTIES, WHETHER EXPRESSED OR IMPLIED, SHALL APPLY TO THE PRODUCT THEREAFTER. WE MAKE NO WARRANTY AS TO THE FITNESS OF THE PRODUCT FOR ANY PARTICULAR PURPOSE OR USE.

THE EXTENT OF OUR LIABILITY UNDER THIS LIMITED WARRANTY IS THE REPAIR OR REPLACEMENT PROVIDED ABOVE AND IN NO EVENT WILL OUR LIABILITY EXCEED THE PURCHASE PRICE PAID BY THE PURCHASER OF THE PRODUCT. UNDER NO CIRCUMSTANCES WILL WE BE LIABLE FOR ANY LOSS, DIRECT, INDIRECT, INCIDENTAL, SPECIAL, OR CONSEQUENTIAL DAMAGE ARISING OUT OF OR IN CONNECTION WITH THE USE OF THIS PRODUCT.

How does state law apply to your warranty ?

THIS WARRANTY GIVES YOU SPECIFIC LEGAL RIGHTS, BUT YOU MAY ALSO HAVE OTHER RIGHTS WHICH VARY FROM STATE TO STATE. SOME STATES DO NOT ALLOW LIMITATIONS ON IMPLIED WARRANTIES OR EXCLUSION OR LIMITATION OF INCIDENTAL OR CONSEQUENTIAL DAMAGE, SO THESE RESTRICTIONS MAY NOT APPLY TO YOU.

AU898F

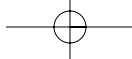

***PORTABLE CD-R/RW PLAYER
STEREO CASSETTE RECORDER
AM/FM STEREO RADIO***

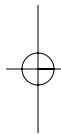
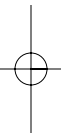

***OWNER'S MANUAL
HK25***

Visit our web site at www.emersonradio.com

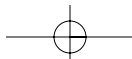

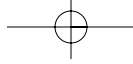

EMERSON
PART NO.: 16-2833
108-01

Printed in China

